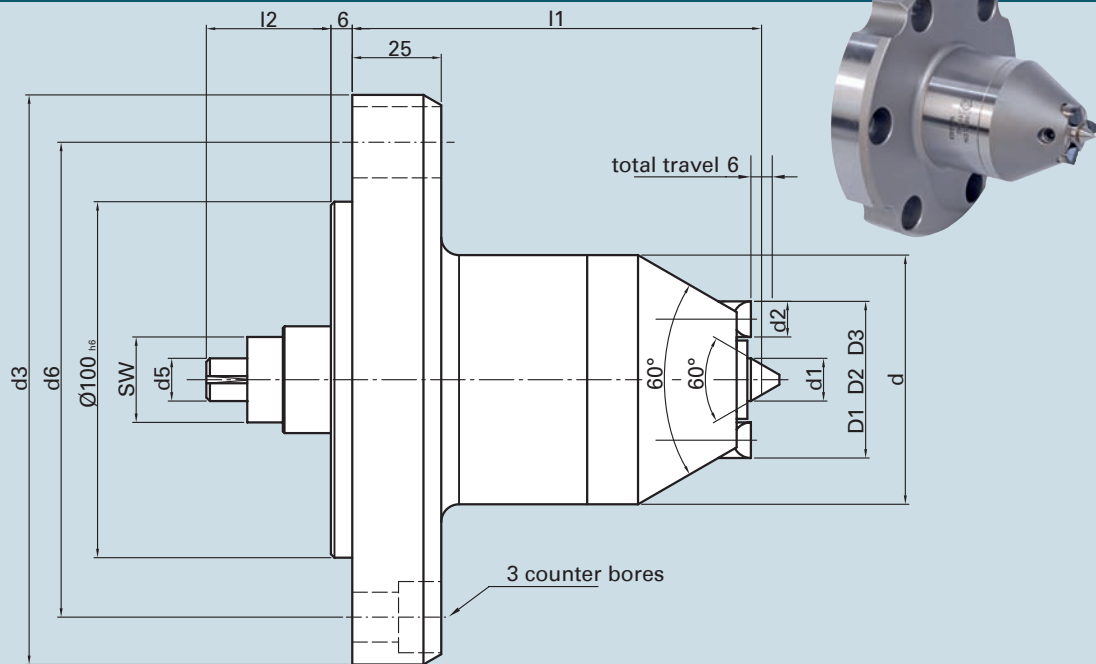
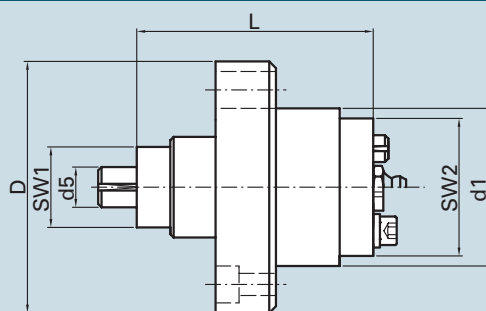

Technical Data – Type FFBH Face Driver

catalogue no.	Type	d	d1	center Ø	d2	d3	SW	d5	d6	l1	l2	drive pin	fastening screw type	fastening screw pcs	clamping diameter		
															D1	D2	D3
63102	FFBH 1	70	9,8	4 – 8,5	8	160	24	12	133.4	115	35	3	M12	3	13	18	26
63103	FFBH 2	70	10	4 – 9	10	160	24	12	133.4	115	35	3	M12	3	26	31	36
63104	FFBH 3	70	12	6 – 11	10	160	24	12	133.4	115	35	3	M12	3	34	39	44
63106	FFBH 4	90	16	10 – 15	15	160	34	12	133.4	132	35	5	M12	3	39	49	59
63107	FFBH 45	100	16	10 – 15	15	160	34	12	133.4	132	35	5	M12	3	49	59	69
63108	FFBH 5	132	16	10 – 15	20	160	34	12	133.4	149	35	5	M12	3	69	84	99

• All face drivers are supplied without drive pins and without center pins.

Technical Data – Type FFBH Hydraulic Unit

catalogue no.	Type	SW	d5	L	d1	SW2	D
63102HE	FFBH 1	24	12	70.5	47	41	75
63102HE	FFBH 2	24	12	70.5	47	41	75
63102HE	FFBH 3	24	12	70.5	47	41	75
63106HE	FFBH 4	34	12	70.5	65	59	93
63106HE	FFBH 45	34	12	70.5	65	59	93
63108HE	FFBH 5	34	12	70.5	87	81	131

The general explanatory notes for this face driver type FFBH can be obtained from the sheet "Technical Data-Type FFBH".

For safe and smooth operation of face driver we recommend exchange of hydraulic unit after 1.500 operating hours.

Furthermore, we offer the option for professional maintenance of the exchanged hydraulic units in our production plant.